

Laptop Protection Plan



Covers Accidents and Mechanical Failure with no deductible.

20% or more of school issued laptops may break in a year! Protect Your Device today! Without coverage, you could pay up to \$200 per claim!

For student devices issued by Hamilton Township School District



Unlimited Claims,
\$0 Deductible!

Enrollment Portal Opens August 25th, 2020

Main Benefits



UNLIMITED CLAIMS



\$0 DEDUCTIBLE OR CO-PAY

What is Covered



ACCIDENTAL DAMAGE



LIQUID DAMAGE



MECHANICAL FAILURE

Price



\$27 One Time

Length



1 Year

Coverage Pricing

HP Chromebooks



1 Year

\$0 Deductible

Repair Cost: \$0
Replacements: \$0

- File incidents online
- Online payments
- Protects against accidents, liquid damage and mechanical failure

Acer Laptops



1 Year Plan

\$0 Deductible

Repair Cost: \$0
Replacements: \$0

- File incidents online
- Online payments
- Protects against accidents, liquid damage and mechanical failure

Click button below to buy coverage online

BUY COVERAGE NOW

or visit
schooldevice.com/hamiltontsd



Payment Methods



Questions? Contact sales@insuritel.com or chat with us online at insuritel.com

For support with your purchase or questions, please visit the website link above for details.

What Isn't Covered and Some Important Terms

Mysterious Loss/Disappearance, Theft, Cosmetic Damage, intentional damage, normal wear and tear, power cord loss. See terms on website for additional details. *Program offered is a protection plan processed by Insuritel but is not an insurance policy. This program is backed by a school issued insurance policy issued after your enrollment portal ends, with claims filed through this coverage.

Affordable Internet Programs

- **AT&T Access Program** - <https://www.att.com/internet/access/>
- **Comcast Internet Essentials** - <https://www.internetessentials.com/covid19>
- **Internet Service Programs** - <https://www.highspeedinternet.com/resources/are-there-government-programs-to-help-me-get-internet-service>
- **FCC Lifeline Program** - <https://www.fcc.gov/general/lifeline-program-low-income-consumers>
- **Verizon Lifeline Program** - <https://www.verizon.com/support/residential/account/manage-account/lifeline-discount>

School Issued Device Log-In Instructions

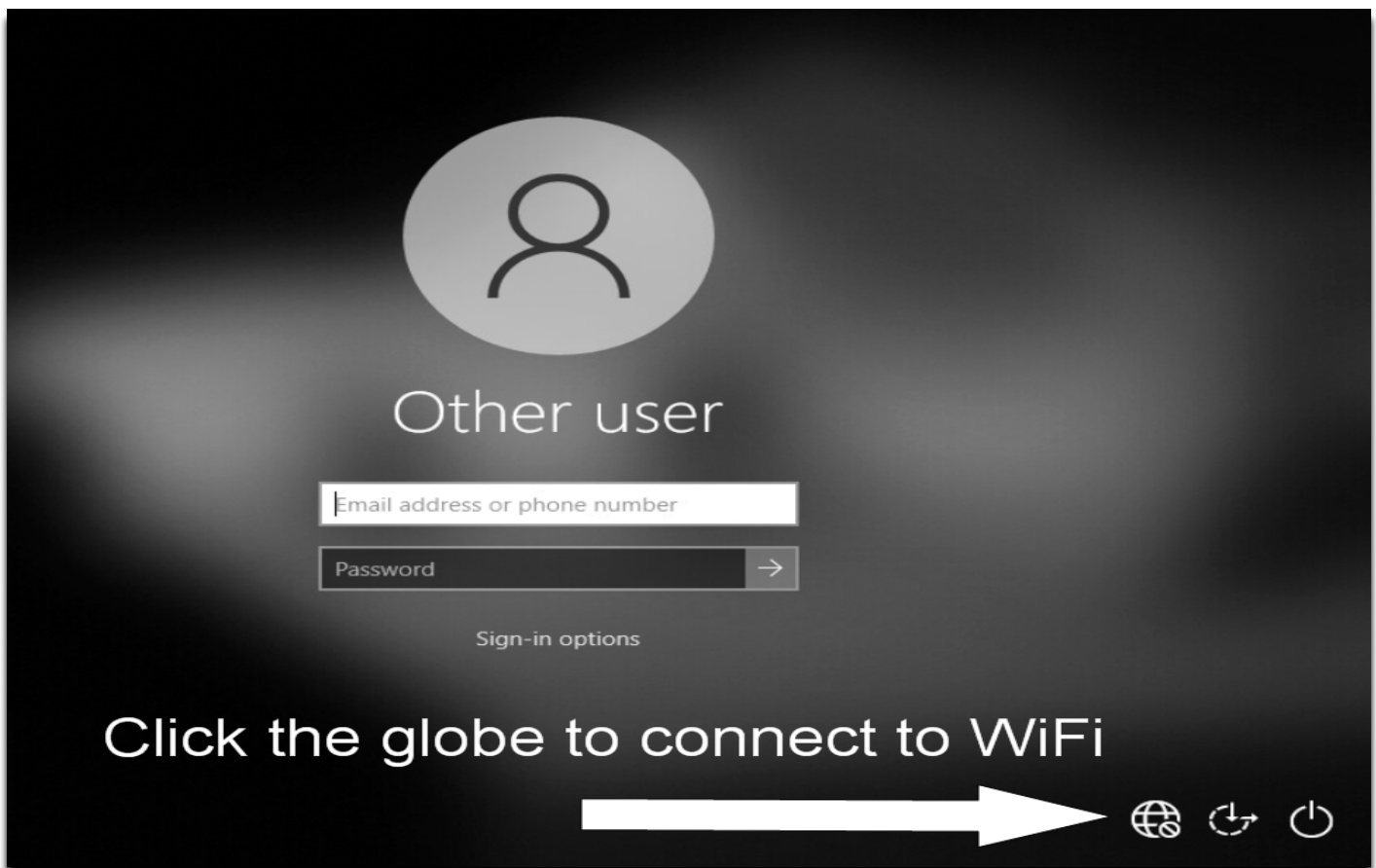

Select Your WiFi and enter password



The image shows a Windows sign-in screen with a large grey user icon and the text "Other user". Below the icon are two input fields: "Email address or phone number" and "Password". A white arrow points from the top-left towards the network selection overlay on the right. The overlay lists several WiFi networks: HTSDWIFI, DIRECT-18-HP M452 LaserJet, DaviesGuest, and DIRECT-69-HP M281 LaserJet Secured. The "DIRECT-69-HP M281 LaserJet Secured" network is highlighted. Below it, there is a prompt to "Enter the PIN from the router label (usually 8 digits)" with a text box and a "Next" button. Below that is a "Cancel" button. At the bottom of the overlay, there are icons for "Wi-Fi", "Airplane mode", and "Mobile hotspot". At the very bottom of the screen are icons for network, refresh, and power.

Click Sign-in options



The image shows the same Windows sign-in screen as above. A large white arrow points downwards from the top of the screen, specifically pointing towards the "Sign-in options" text located below the "Password" input field.

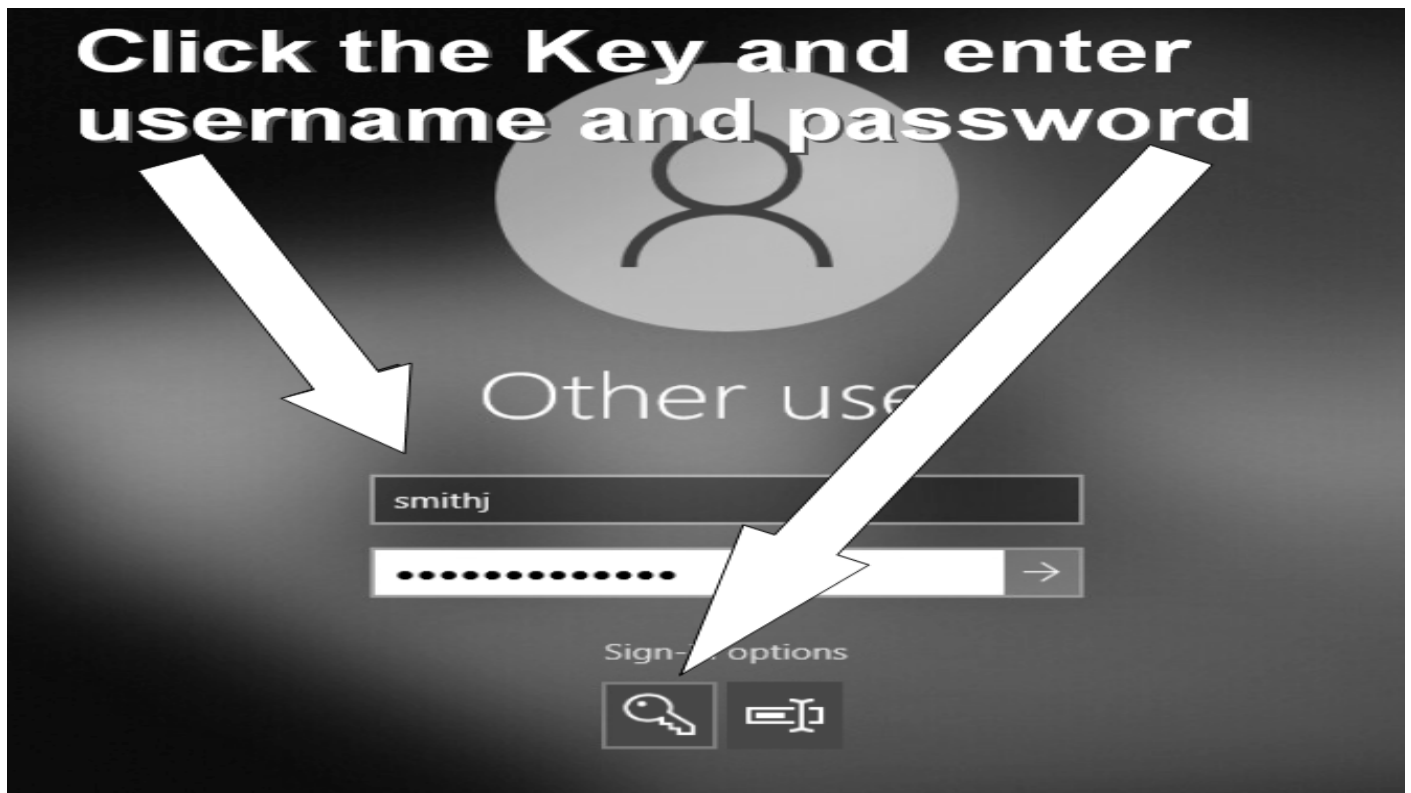

Windows 10 Laptop Login:

Last Name, First Initial & Month & Day of Birth (smithj1013)

Google/Chromebook Login:

Last Name, First Initial & Day of Birth @students.hamiltonschools.org

smithj1013@students.hamiltonschools.org

Password is your student's lunch pin

For Tech Support:

[Click here](#)

Or type in the following address

<https://forms.gle/u5TiuLoKqhcPGc1Z6>